

Length

Width



## Decorative mesh PC-Futura 3110

Figure drawn to scale 1:1

Decorative mesh PC-Futura 3110



### Available materials\*



Stainless steel

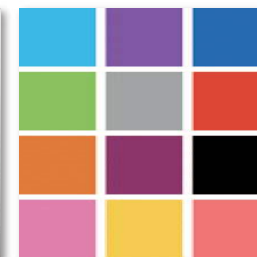

Powder-coated

Available in standard formats and individual dimensions (w x l) of at least 300 x 300 mm to maximum 1,250 x 2,500 mm, as well as in sheet thicknesses of 4.0 mm.

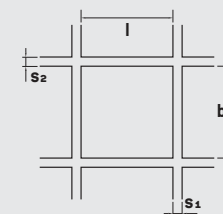

Decorative mesh  
l = 14.2 mm  
b = 110 mm  
Weft wire  $s_1 = 4.0$  mm  
Warp wires  $s_2 = 3.0$  mm

\* Not all materials are available in all formats and sheet thicknesses.



SELECT AND ORDER  
ONLINE

All variants of this product can be found online in our shop. Simply enter the product name in the online search.

